

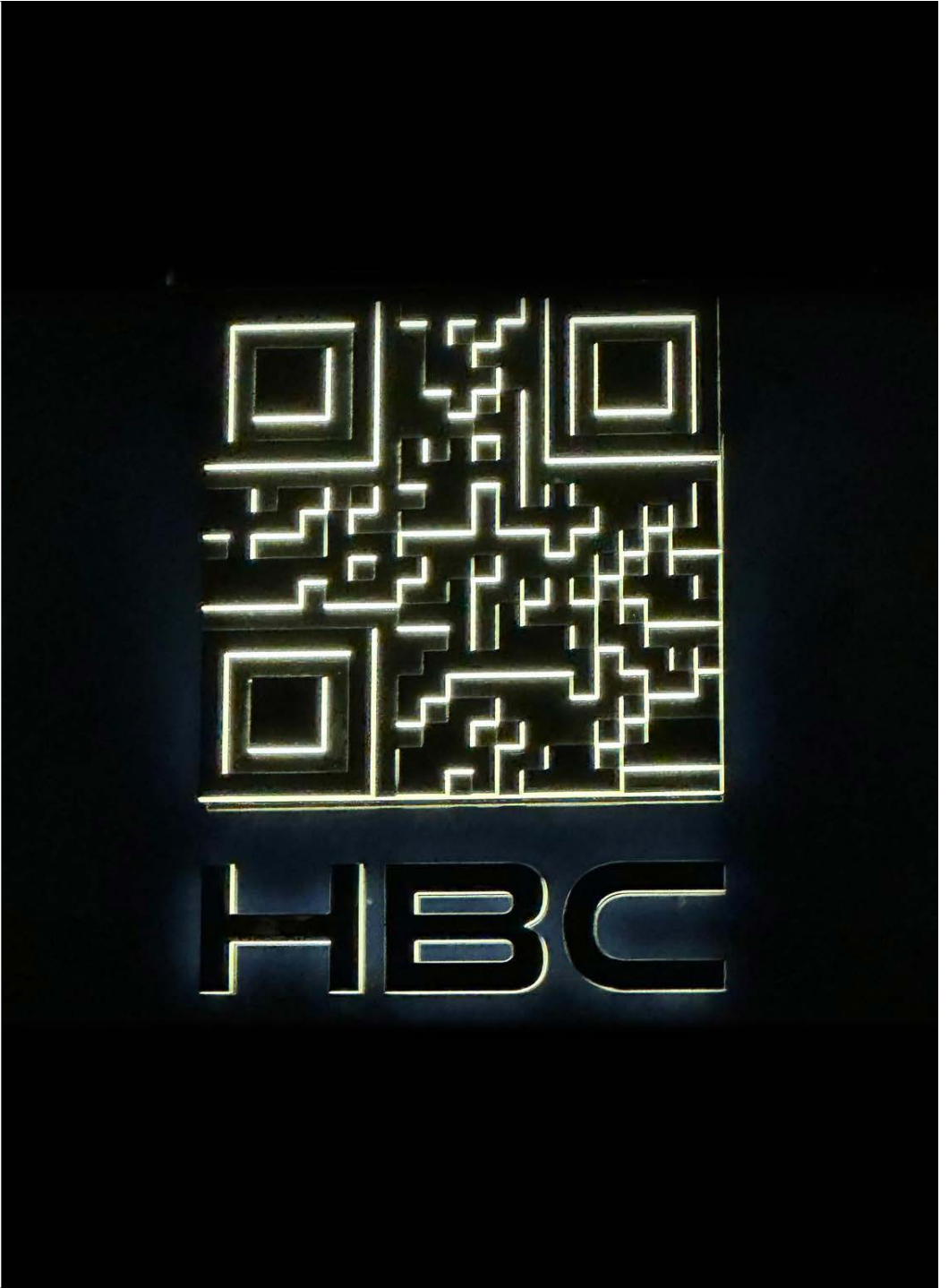

HBC

85.6m (280' 8") | ABEKING & RASMUSSEN | 2009/2024





BEACH CLUB



BEACH CLUB



BEACH CLUB



BEACH CLUB



MAIN AFT DECK



MAIN AFT DECK

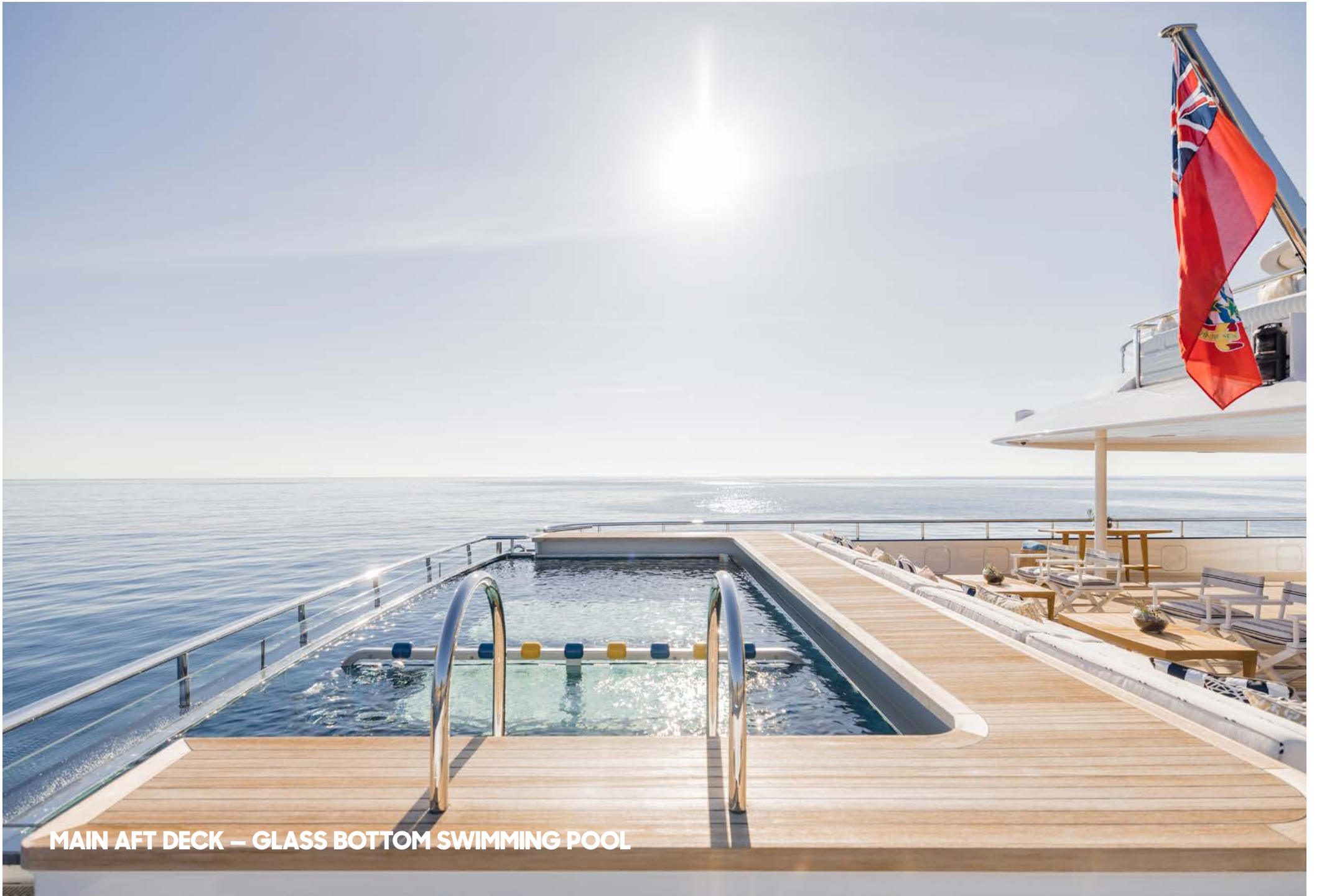

MAIN AFT DECK – GLASS BOTTOM SWIMMING POOL



MAIN SALON



MAIN SALON



MAIN SALON



MASTER STATEROOM



MASTER STATEROOM



MASTER STATEROOM



MASTER BATHROOM



MASTER BATHROOM



MASTER BATHROOM



OWNER'S STUDY



VIP CABIN



VIP CABIN



VIP CABIN - BATHROOM



MAIN DECK – DOUBLE PORT CABIN 1



MAIN DECK – DOUBLE PORT CABIN 2



MAIN DECK – DOUBLE PORT CABIN 2 BATHROOM



MAIN DECK – DOUBLE PORT CABIN 3



MAIN DECK – DOUBLE STARBOARD CABIN 1



MAIN DECK – DOUBLE STARBOARD CABIN 2



MAIN DECK – DOUBLE STARBOARD CABIN 2 BATHROOM



MAIN DECK – DOUBLE STARBOARD CABIN 3



LOWER DECK – DOUBLE PORT CABIN



LOWER DECK – DOUBLE PORT CABIN FORWARD



LOWER DECK – DOUBLE PORT CABIN FORWARD BATHROOM



LOWER DECK – DOUBLE STARBOARD CABIN



LOWER DECK – CINEMA ROOM



LOWER DECK – CINEMA ROOM



UPPER DECK – SPA



GYM



UPPER DECK – DINING



UPPER DECK – DINING



BOW



BOW



SKY LOUNGE



SKY LOUNGE



SKY LOUNGE



BRIDGE DECK – AFT



SUN DECK



SUN DECK



SUN DECK



SUN DECK – JACUZZI



SUN DECK – JACUZZI



ELEVATOR



ELEVATOR



BRIDGE



BRIDGE



SPECIFICATIONS

DIMENSIONS

Length	85.6m (280' 8")
Beam	12.4m (40' 8")
Draft	3.45m (11' 4")

GENERAL

Year	2009/2024
Builder	Abeking & Rasmussen
Exterior Design	Reymond Langton Design Ltd
Interior Design	Reymond Lagnton Design/ Winch Design
Hull Construction	Steel
Superstructure	Aluminium
Gross Tonnage	2,150

ACCOMMODATION

Number of Cabins	11 (Doubles)
Total Guests	12
Total Crew	28

CERTIFICATIONS

Flag	UK
Port of Registry	Rye
Class	MCA Lloyds

TECHNICAL INFORMATION

Engines	2 x Caterpillar 3516 DITA 1,999 hp x 2 (3,998 hp)
Generators	3 x Caterpillar C18 1 x 3056 Emergency Generator
Fuel Capacity	160,000 litres
Water Capacity	35,000 litres
Fuel Consumption	528 litres/hr
Range	6,690 nm @ Cruising Speed
Maximum Speed	16.5 knots
Cruising Speed	13.5 knots
Stabilisers	At anchor and underway

TENDERS & TOYS

- 2 x Custom tender YachtWerft Mayer 20.25 ft, 12 pax + 2 crew
- 1 x Pirelli RIB tender 7.5m
- 1 x Zodiac Rescue Tender

WATERSPORTS

- 3 x Wave Runners
- 5 x SeaBobs
- 1 x Efoil
- 1 x Radin E Surf
- 4 x Wake Boarding inc 1 junior
- 4 x Kitesurfing gear with boards and bindings
- 2 x SUP Paddleboards
- 2 x Glass bottom Kayaks
- 1 x Jelly Fish Pool and 2 x hard platforms
- 6 x Dive Gear in a range of sizes. (Local dive instructor will be required for insurance)
- Range of towable toys

GENERAL

- Air Conditioning
- WiFi

WEEKLY CHARTER RATES - MYBA TERMS

SUMMER

€950,000 per week (high rate)

€850,000 per week (low rate)

WINTER

\$950,000 per week (high rate)

\$850,000 per week (low rate)

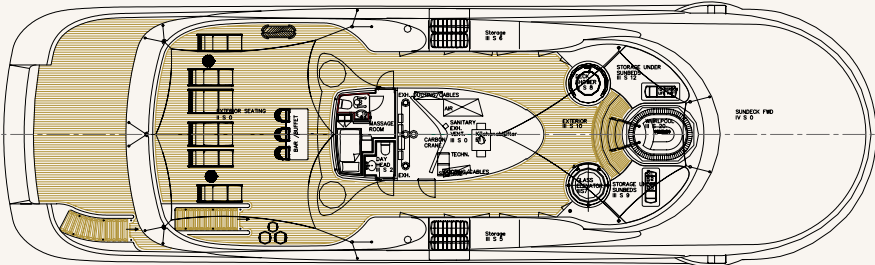

SUN DECK

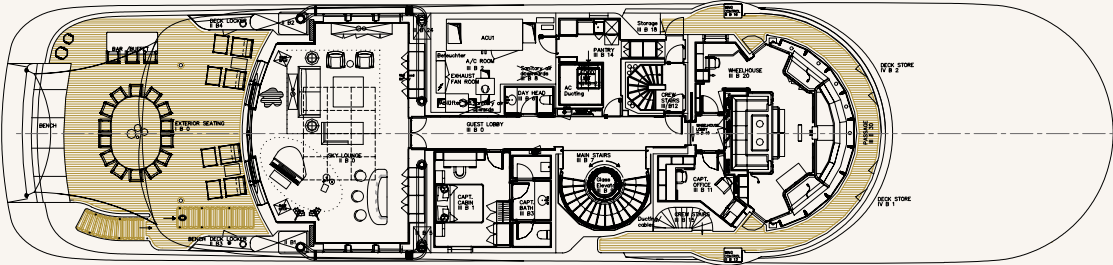

BRIDGE DECK

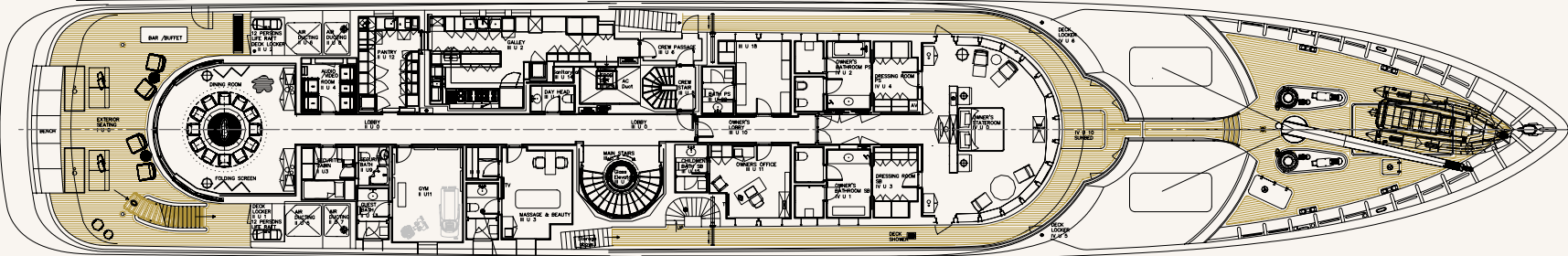

UPPER DECK

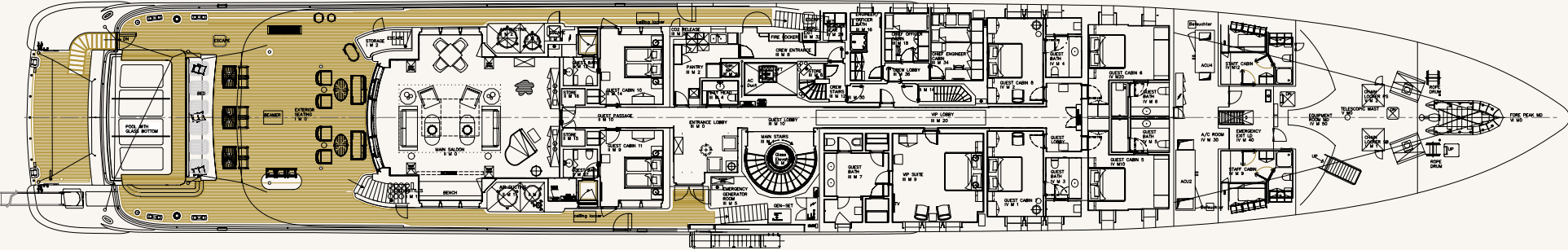

MAIN DECK

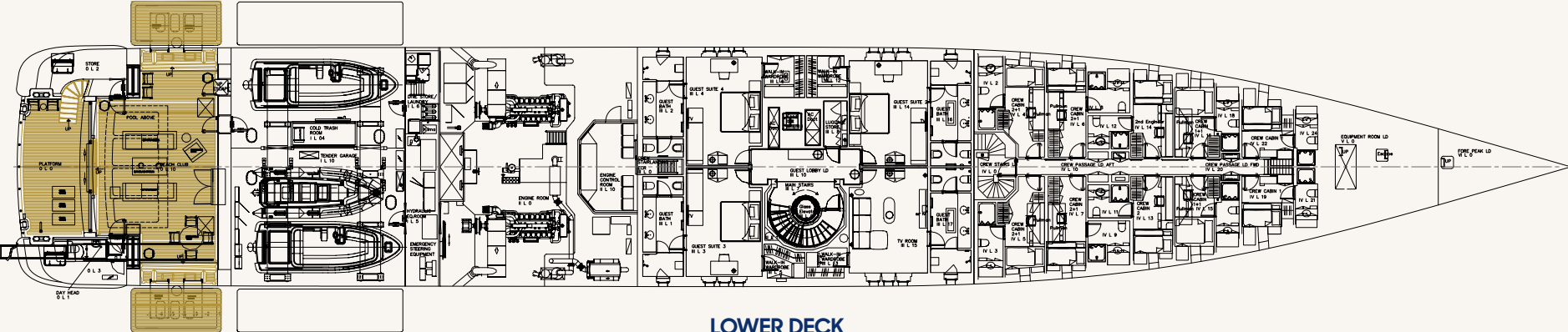

LOWER DECK

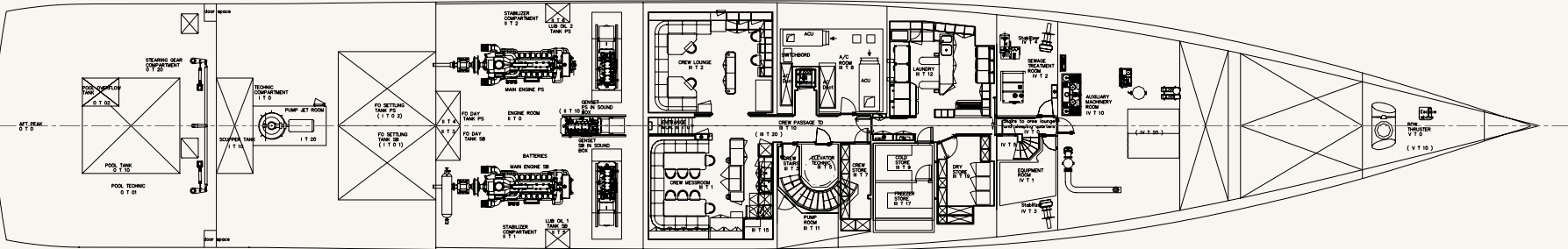

TANK DECK



HBC